

# KWL

hydrostatic head level transmitter for wastewater

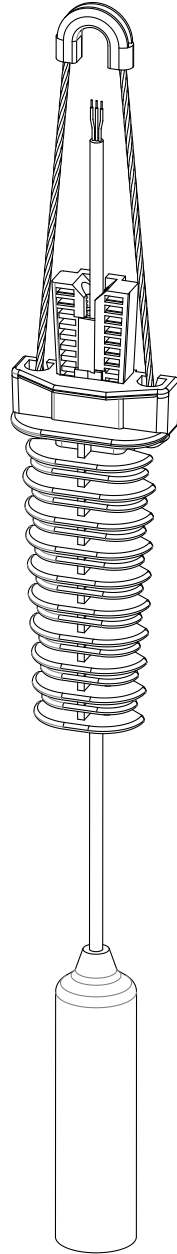

technical documentation EN Rev. of 12/01/2023

# CONTENTS

---

<b>1-WARRANTY</b>	page 3
<b>2-PRODUCT</b>	page 4
<b>3-PERFORMANCE SPECIFICATIONS</b>	page 5
<b>4-DIMENSIONS</b>	page 6
<b>5-INSTALLATION</b>	page 7
<b>6-ELECTRICAL CONNECTIONS</b>	page 8
<b>7-FACTORY TEST AND QUALITY CERTIFICATE</b>	page 12

## 1-WARRANTY

---

Products supplied are guaranteed for a period of 12 (twelve) months from delivery date according to the conditions specified in our sale conditions document.

Producer can choose to repair or replace the Product.

If the Product is repaired it will maintain the original term of guarantee, whereas if the Product is replaced it will have 12 (twelve) months of guarantee.

The warranty will be null if the Client modifies, repair or uses the Products for other purposes than the normal conditions foreseen by instructions or Contract.

In no circumstances shall the producer be liable for direct, indirect or consequential or other loss or damage whether caused by negligence on the part of the company or its employees or otherwise howsoever arising out of defective goods

## 2- PRODUCT

The separation liquid absence between the membrane and the pressure sensor, “Dry-Pressure” measurement technology, allows to have overpressure superior technological performance, small thermal drift, high stability and accuracy.

The different possible configurations of the KWL level transmitter, make it suitable for most industrial sectors and in different operating conditions.

For these characteristics KWL is ideal for the hydrostatic levels measurement in process automation.

Cable extension with suspension mounting.

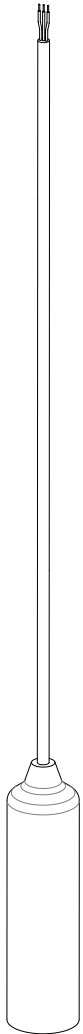

Con attacco al processo 2”  
GAS

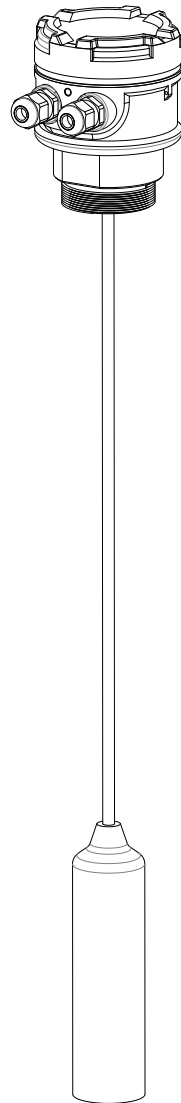

With mounting clamp.

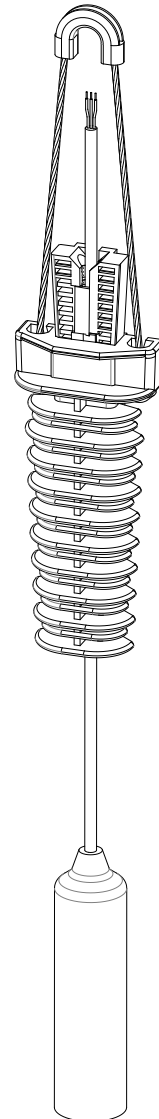

### 2.1 IDENTIFICATION

Each meter has an adhesive identification plate on which are the meter main data. The following picture describes the information and data on the identification plate.

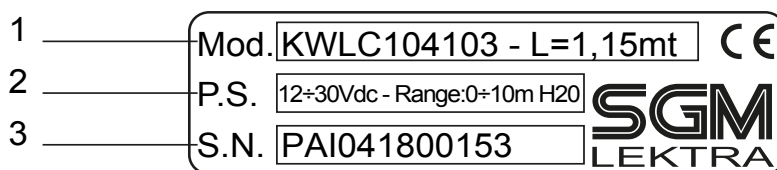

1. Product code
2. Power supply / Range
3. Serial number

## 3-FEATURES

---

**Power supply**

12÷30Vdc (2-wires)

**Measuring range**

from 0÷0.4mH<sub>2</sub>O to 0÷20mH<sub>2</sub>O

**Wetted part material**

PVC

**Shielded cable material**

PU Ø7.5mm

**Process connection:**

Suspension cable type; mounting clamp (opt.); attacco 2" GAS

**Output**

4÷20mA

**Overload capacity**

1.5 times of F.S.

**Max. accuracy**

±0.5%F.S.

**Stability:**

>±0.1%FS for year

**Storage temperature**

-20° ÷ +70°C

**Working temperature**

-10° ÷ +50°C

**Compensazione di temperatura**

nel range di esercizio

**Thermal shift**

0.02%F.S./°C

**Wetted part protection**

IP68

**Housing (KWLC)**

epoxy painted aluminium

**Housing protection**

IP67

**J-BOX**

Polycarbonate

**J-BOX protection**

IP65

# 4-DIMENSIONS

## 4.1 MECHANICAL DIMENSIONS VERSION "C"

L (mt)
5
10
15
25
30
35
40

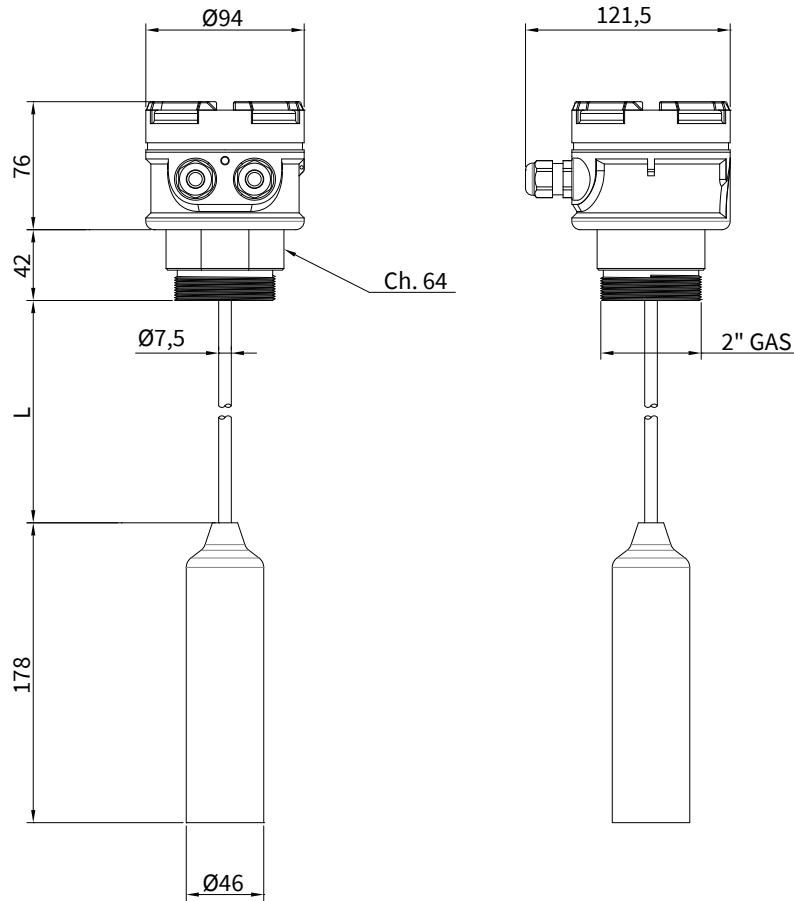

## 4.2 DIMENSIONS J-BOX

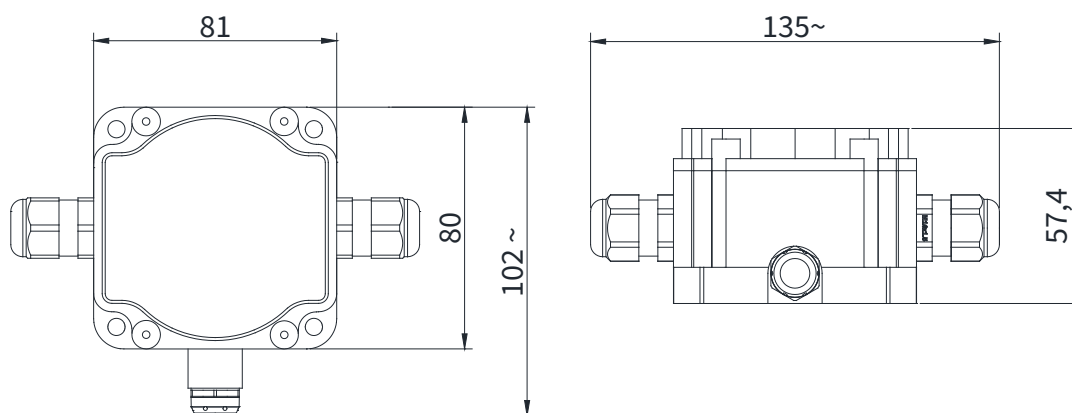

## 5-INSTALLATION

---

KWL\_ series pressure transmitters can be installed on pressure joint of pipeline.

A cut-off valve should be added between pressure joint and pipeline to make it easier for installation and debugging.

### 5.1 AVAILABLE MEASURING RANGE

0 ÷ 0,4m H<sub>2</sub>O

0 ÷ 1m H<sub>2</sub>O

0 ÷ 2m H<sub>2</sub>O

0 ÷ 5m H<sub>2</sub>O

0 ÷ 10m H<sub>2</sub>O

0 ÷ 20m H<sub>2</sub>O

0 ÷ 50m H<sub>2</sub>O

0 ÷ 100m H<sub>2</sub>O

0 ÷ 200m H<sub>2</sub>O

# 6-ELECTRICAL CONNECTIONS

KWL level transmitters are 2-wire loop powered on 12÷30Vdc voltage range. Some examples of electrical connections are shown below.

Functions	Wire
+24	Red
0V	Black
GND	Yellow/Green



## 6.1 System with display and control

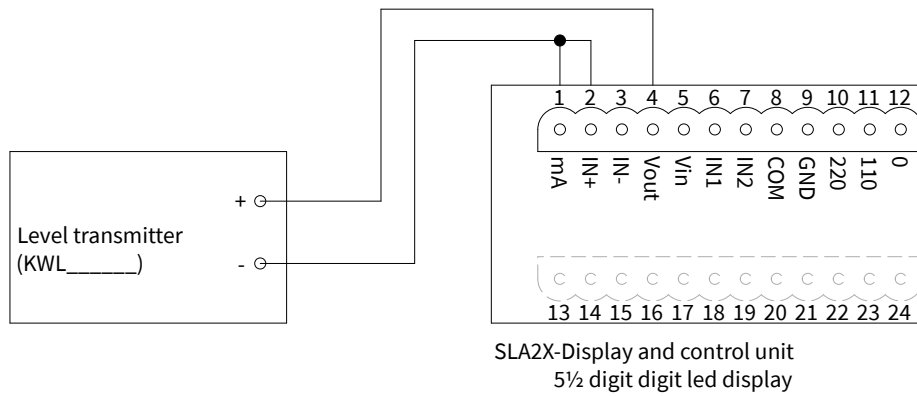



### 6.2 Loop powered display two wires

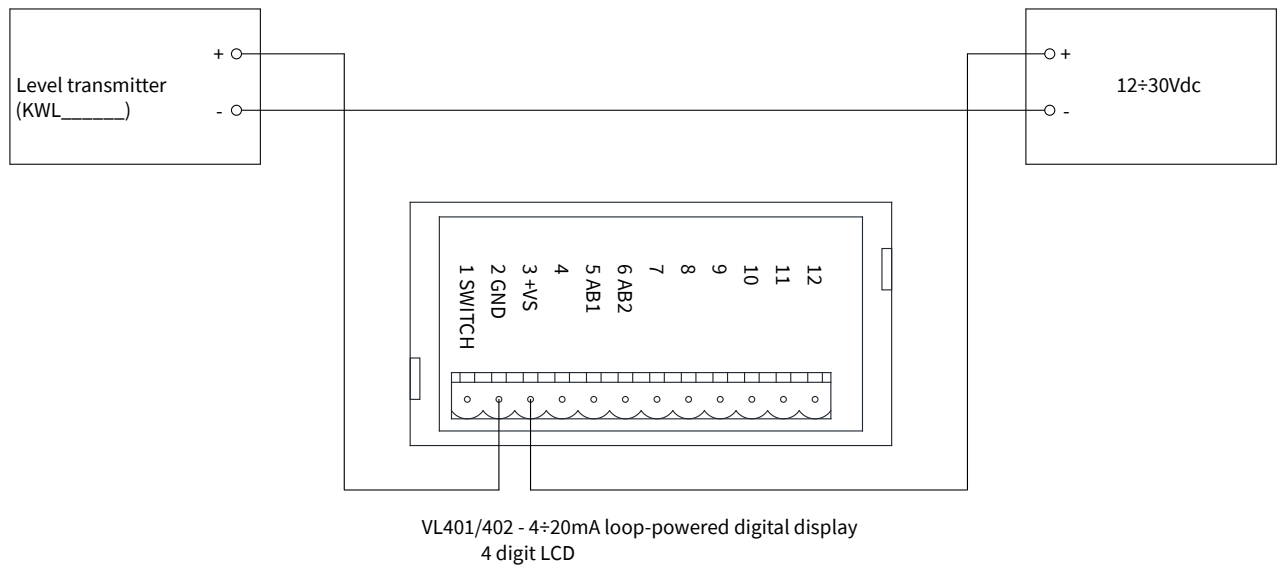

### 6.3 CONNECTIONS J-BOX

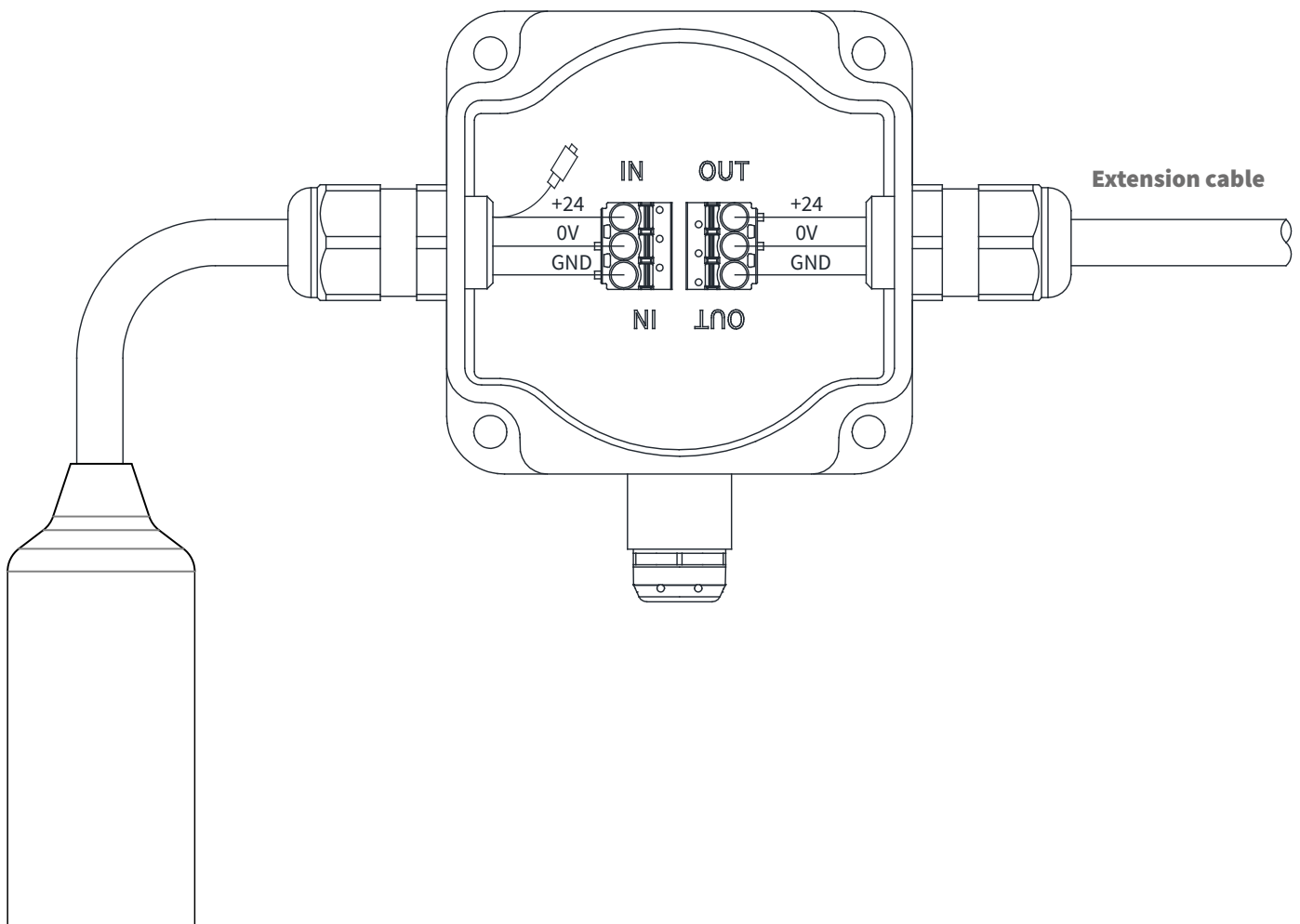





# 7-FACTORY TEST AND QUALITY CERTIFICATE

---



In conformity to the company and check procedures I certify that the equipment:

(Level transmitter)

is conform to the technical requirements on Technical Data and it is made in conformity to the procedure

Quality Control Manager: ..... Production and check date: .....